

## GROSSMONT COLLEGE FACILITIES COMMITTEE

### FACILITIES PROJECT REQUEST PRIORITIZATION FOR YEAR 2022-2023

Rank	Title	Description	Reason for Rating	Cost
1	<b>FPR 23-05 Mental Health Space</b>	Remodeling current space to add at least two offices and one storage.	Recognize the importance of mental health care for students and employees. Mental health plays a significant role in student academic success, retention, and equity.	Depending on option chosen \$400,000 to \$2,000,000
2	<b>FPR 23-01 CVTE Flooring</b>	Remove carpet and replace with rubber resilient flooring so students can roll CVTE equipment across the floor safely.	Needed for student function and safety.	\$14,950
3	<b>FPR 23-02 Bio Chairs</b>	Replace worn out stools with chairs with back support.	Biology has submitted FPR for new chairs for the last four years with approval, but funding was not available. Chairs need back support for long lab hours.	\$16,000
4	<b>FPR 23-03 Culinary Electrical</b>	Add pulldown electrical from the ceiling to replace extension cords taped across the floor. Correct overloaded circuits that keep popping.	Corrections of electrical safety and upgrades are needed. An important project for student and staff safety.	\$75,000
5	<b>FPR 23-10 Bio Cabinets</b>	Bldg 30-128 biology lab need more upper cabinet space above counter.	Biology has been FPR requesting new cabinets for the last three years with approval, but funding was not available. The cabinets provide student and tech with supplies needed in the lab.	\$50,000
6	<b>FPR 23-09 Nature Trail</b>	Install water-bar steps for erosion and safety, repair fencing for security, and remove large invasive vegetation that is encroaching on the natural habitat.	The work is needed but does not serve as many students as other labs.	\$200,000
7	<b>FPR 23-08 Transfer Center Space</b>	Move Transfer Services and Adult Re-Entry to Bldg 60-145 to gain needed space in Bldg 10 for Umoja and Puente Program.	This project is needed for our student services in the near future and worthy of funding.	\$400,000

# FPR - Facilities Project Request Scorecard - Facilities Committee

Project Title: FPR 23-05 Mental Health Space

FC Member:

*Possible Criteria Scores: 0-5 with 5 the highest score*

REFER TO QUESTION		CRITERIA	CRITERIA SCORE
<b>Benefits and Impacts</b>			
1	E,G	Direct/indirect benefit for students	0
2	E,G	Direct/indirect impact on students <b>(0 = Impact, 5 = No Impact)</b>	0
3	F, H	Benefit for other depts., services, programs	0
4	F, H	Impact on other depts., services, programs <b>(0 = Impact, 5 = No Impact)</b>	0
5	C	Improves health & safety	0
6	A-J	Project Physical Feasibility	0
<b>Project Support</b>			
7	H	Program Review Committee	0
8	H	Department or Program Annual Plan	0
9	H	College or District Facilities Master Plan	0
10	H	Grossmont College Strategic Plan	0
11	H	Educational Master Plan	0
12	H	Student Success and Equity	0
13	H	Sustainability Impact	0
14	H	ADA Accessibility	0
<b>Budget</b>			
16	I	Potential/Recommended funding source	0
17	I	One-Time Cost Effectiveness	0
18	I	Projected Long-Term Effectiveness	0
19	I	Effective Life-Cycle (Replacement Time)	0
20	I	Cost Feasibility	0
<b>Timeline</b>			
21	J	Immediate Emerging Need	0
22	J	Project Start/Finish Feasibility	0
<b>Project Total Score Out of %100</b>			<b>0</b>
Comments:			
<b>Facilities Director Report</b>			
	<b>COST</b>	<b>\$400,000 to \$2,000,000</b>	
2	Director's (1)	Construction impact on students/staff <b>(0 = Impact, 5 = No Impact)</b>	0
5	Director's (2)	Continual impact on FMO <b>(0 = Impact, 5 = No Impact)</b>	5
6	Director's (3)	Construction impact on FMO <b>(0 = Impact, 5 = No Impact)</b>	2
11	Director's (4)	Project Physical Feasibility	2
15	Director's (5)	Project Support Feasibility	5
19	Director's (6)	Cost Feasibility	3
23	Director's (7)	Project Start/Finish Feasibility	1
<b>Project Total Score Out of %100</b>			<b>51</b>
Comments:		The project is definitely needed. Currently there is no space to move the Mental Health Department. Options are to create two offices and a storage in the space they occupy (\$400,000, see drawing below) or may need to bump into the EOPS area and modify or move them (\$2,000,000). The program would be displaced to do construction for about three months. The project will take about nine months from start to finish to be done in the current space, or over a year to expand into EOPS. Project includes public bid contract, project manager, architect, and contractors.	

# FPR 23-05 Mental Health Space

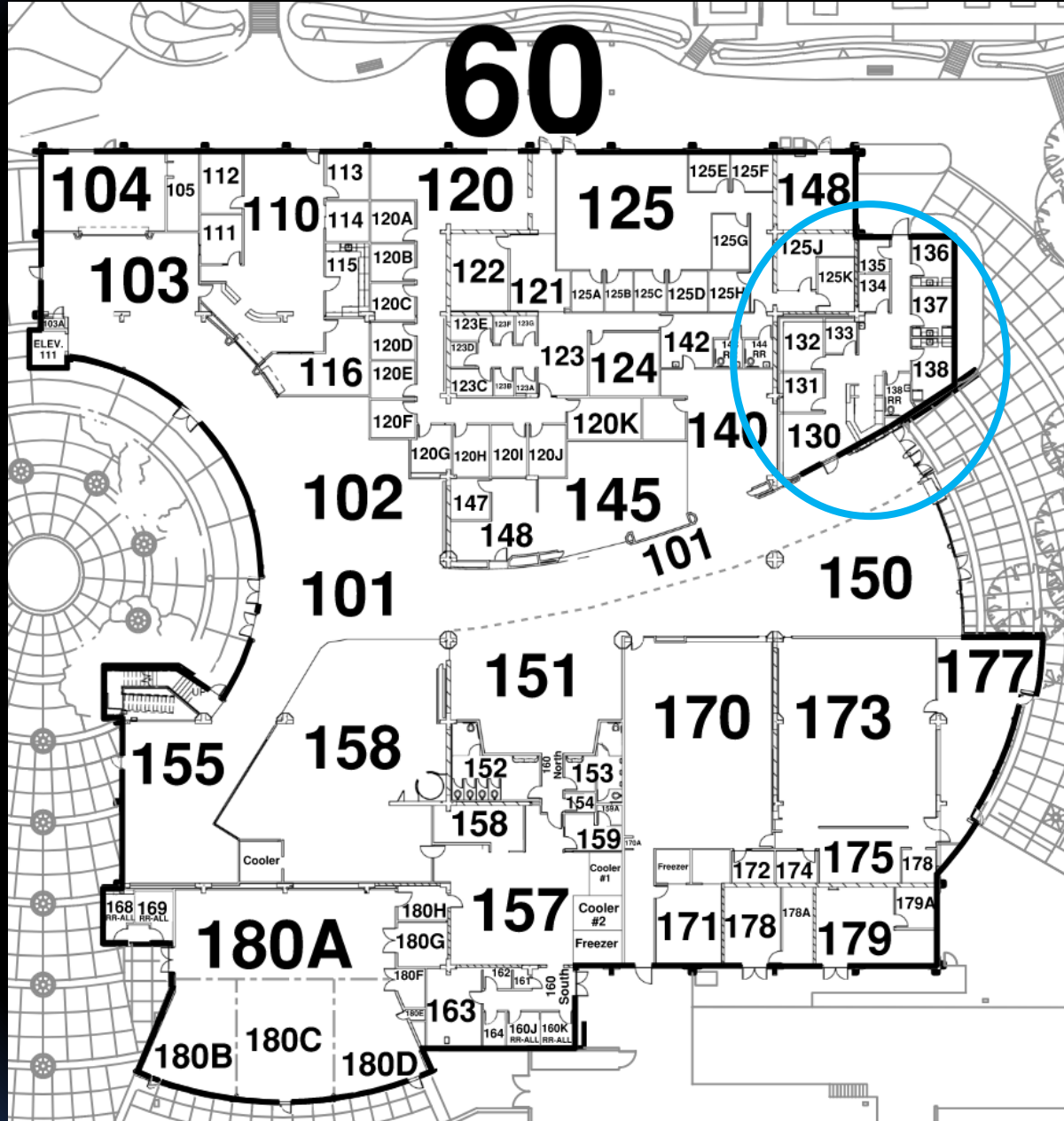

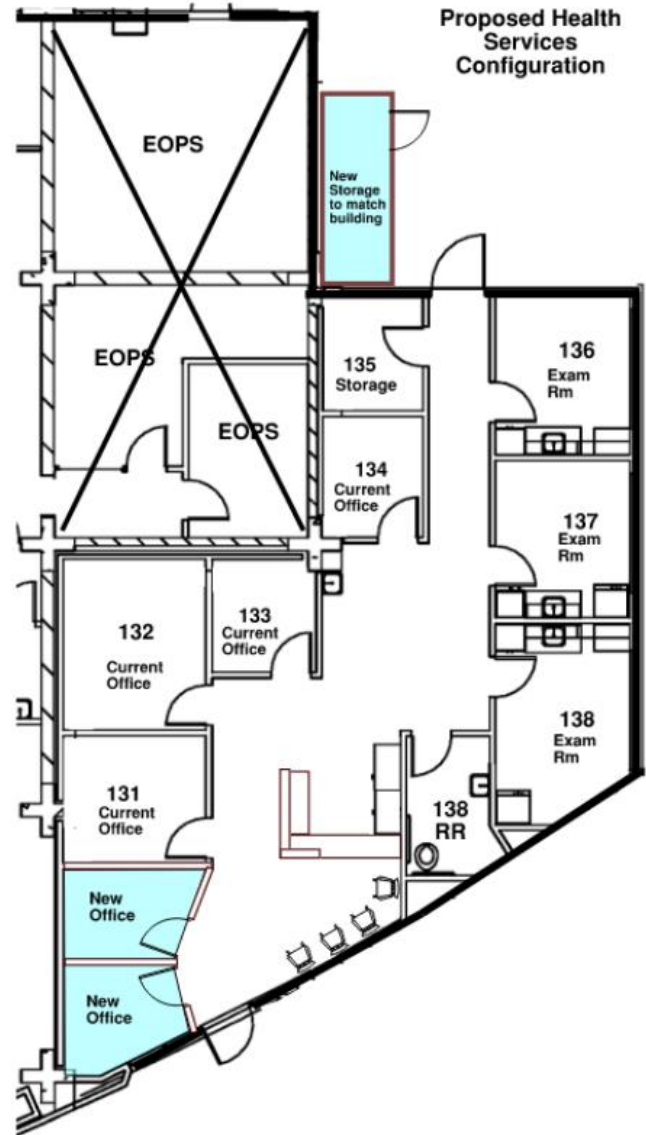
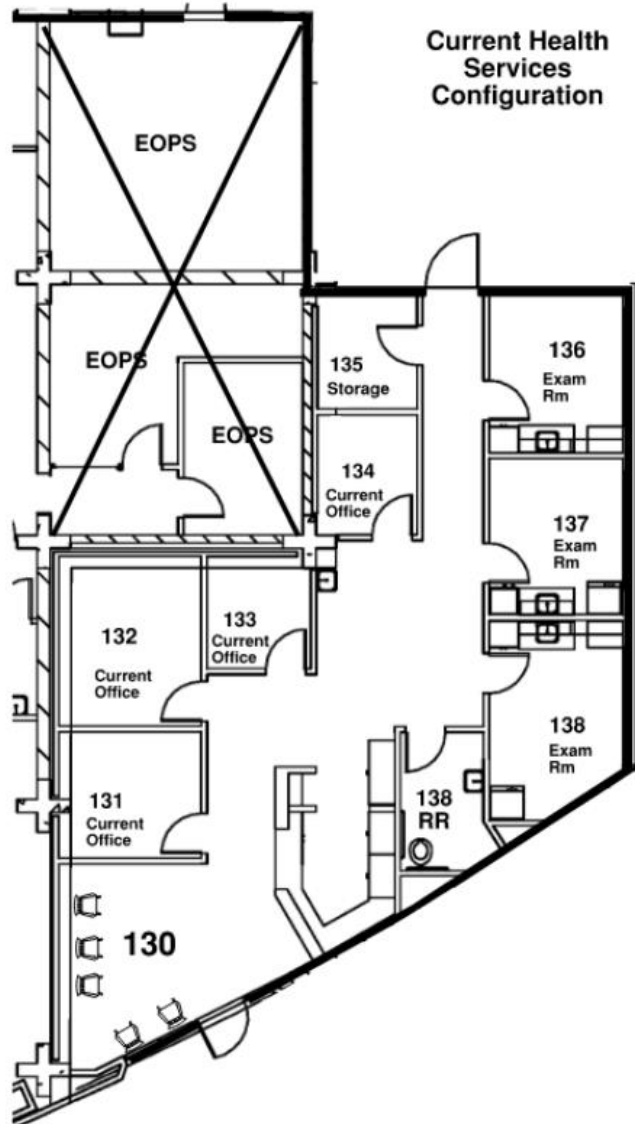

Before



After

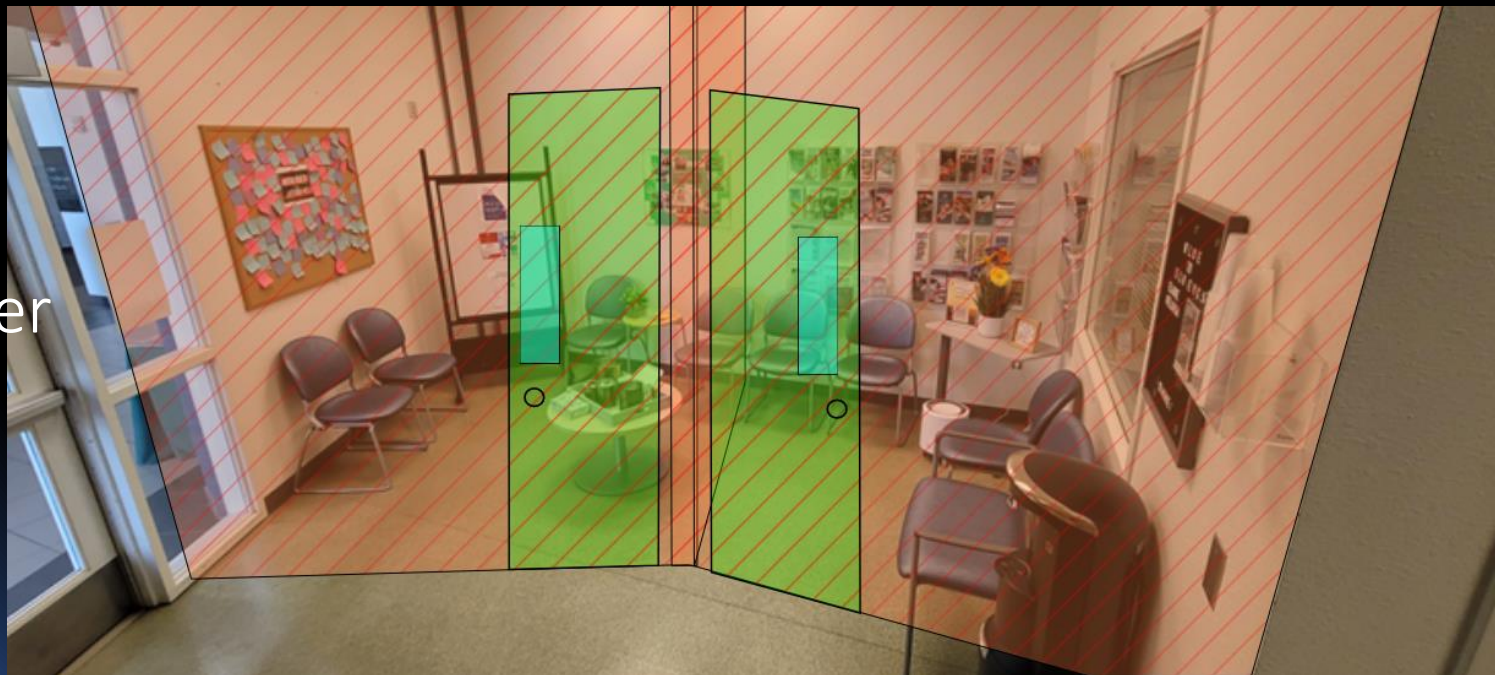

Before



Add exterior storage to match building

After

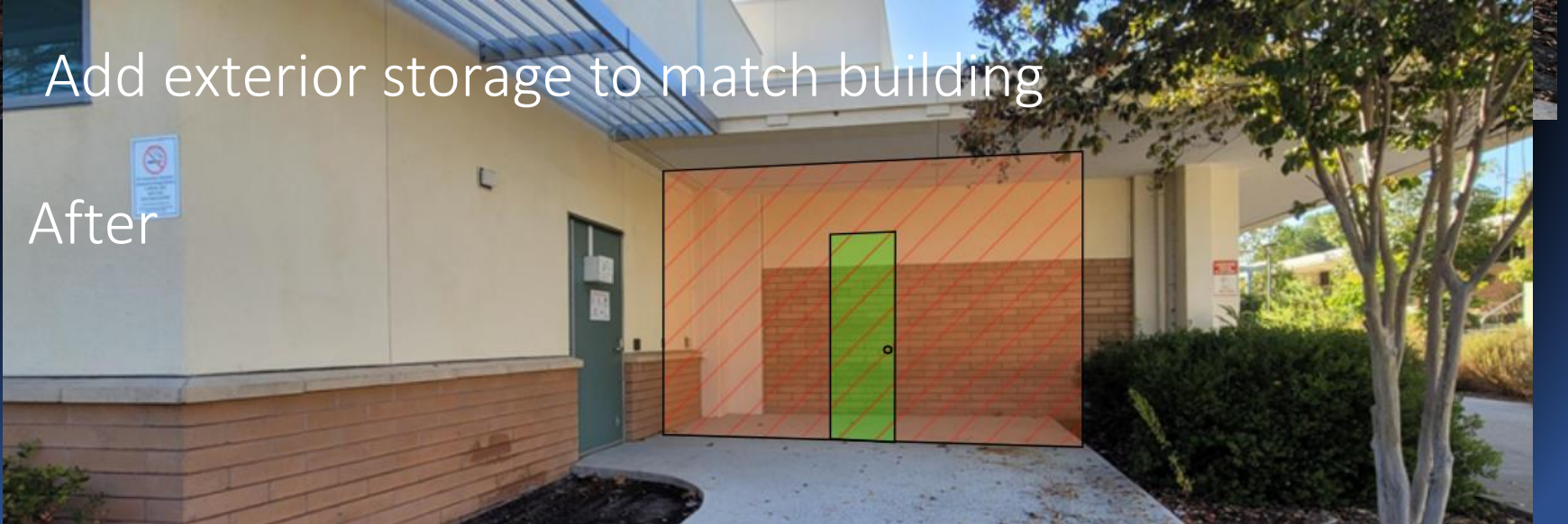

		Facilities Director Report	
	<b>COST</b>		<b>\$400,000 to \$2,000,000</b>
2	Director's (1)	Construction impact on students/staff (0 = Impact, 5 = No Impact)	0
5	Director's (2)	Continual impact on FMO (0 = Impact, 5 = No Impact)	5
6	Director's (3)	Construction impact on FMO (0 = Impact, 5 = No Impact)	2
11	Director's (4)	Project Physical Feasibility	2
15	Director's (5)	Project Support Feasibility	5
19	Director's (6)	Cost Feasibility	3
23	Director's (7)	Project Start/Finish Feasibility	1
			<b>Project Total Score Out of %100</b>
			<b>51</b>
Comments:	<p>The project is definitely needed. Currently there is no space to move the Mental Health Department. Options are to create two offices and a storage in the space they occupy (\$400,000, see drawing below) or may need to bump into the EOPS area and modify or move them (\$2,000,000). The program would be displaced to do construction for about three months. The project will take about nine months from start to finish to be done in the current space, or over a year to expand into EOPS. Project includes public bid contract, project manager, architect, and contractors.</p>		

# FPR 23-01 CVTE Flooring in Bldg 34-224

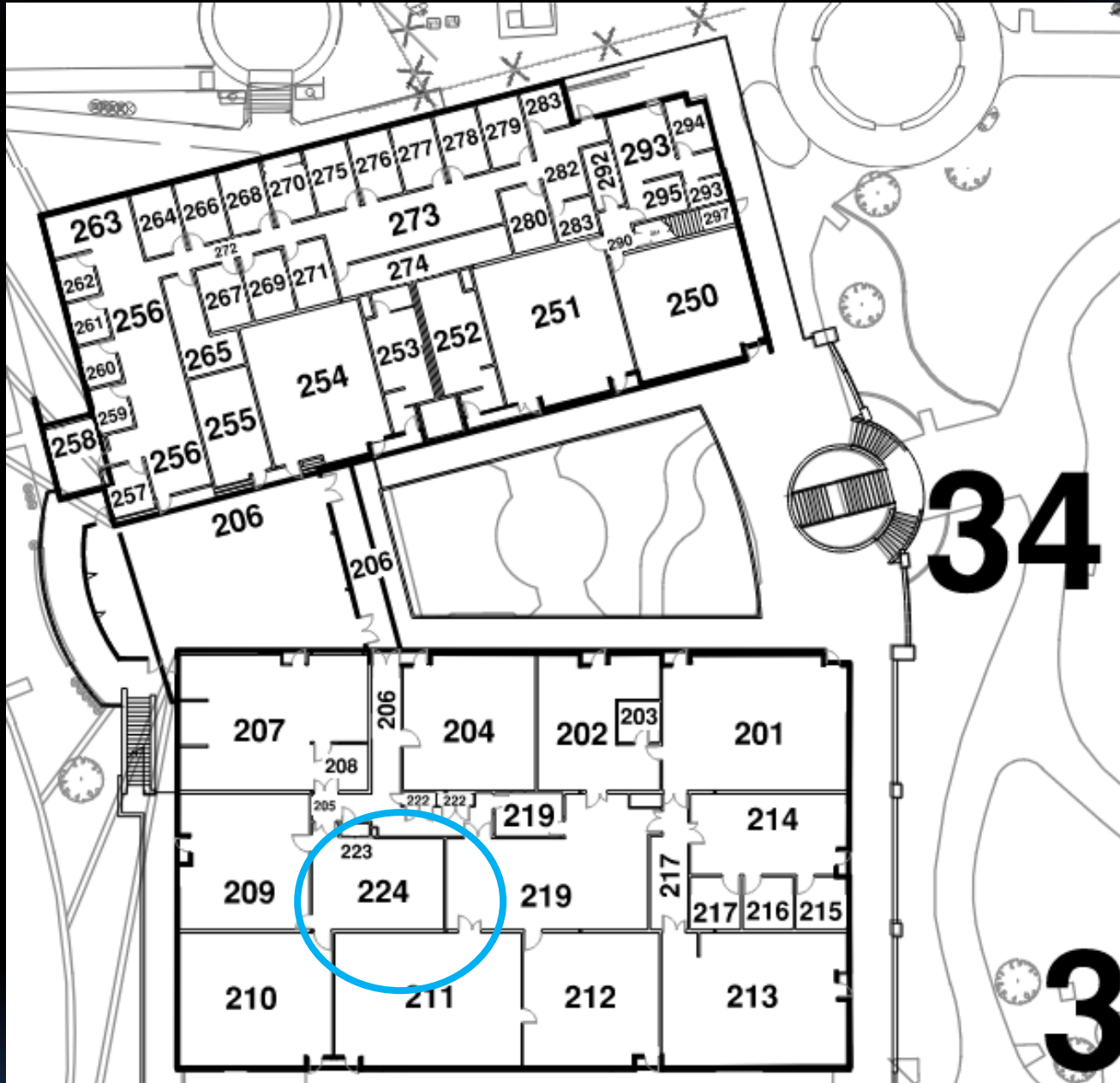



# FPR 23-01 CVTE Flooring in Bldg 34-224



		Facilities Director Report	
	<b>COST</b>		<b>\$14,950.00</b>
2	Director's (1)	Construction impact on students/staff (0 = Impact, 5 = No Impact)	4
5	Director's (2)	Continual impact on FMO (0 = Impact, 5 = No Impact)	5
6	Director's (3)	Construction impact on FMO (0 = Impact, 5 = No Impact)	4
11	Director's (4)	Project Physical Feasibility	5
15	Director's (5)	Project Support Feasibility	5
19	Director's (6)	Cost Feasibility	5
23	Director's (7)	Project Start/Finish Feasibility	3
			<b>Project Total Score Out of %100 89</b>
Comments:		May be difficult to schedule with contactor to do the one week of work between semesters if the lab is used year round. Any equipment currently in the space will need to be removed in-house before work can begin.	

# FPR 23-02 Bio Chairs in Bldg 30-138 & 154

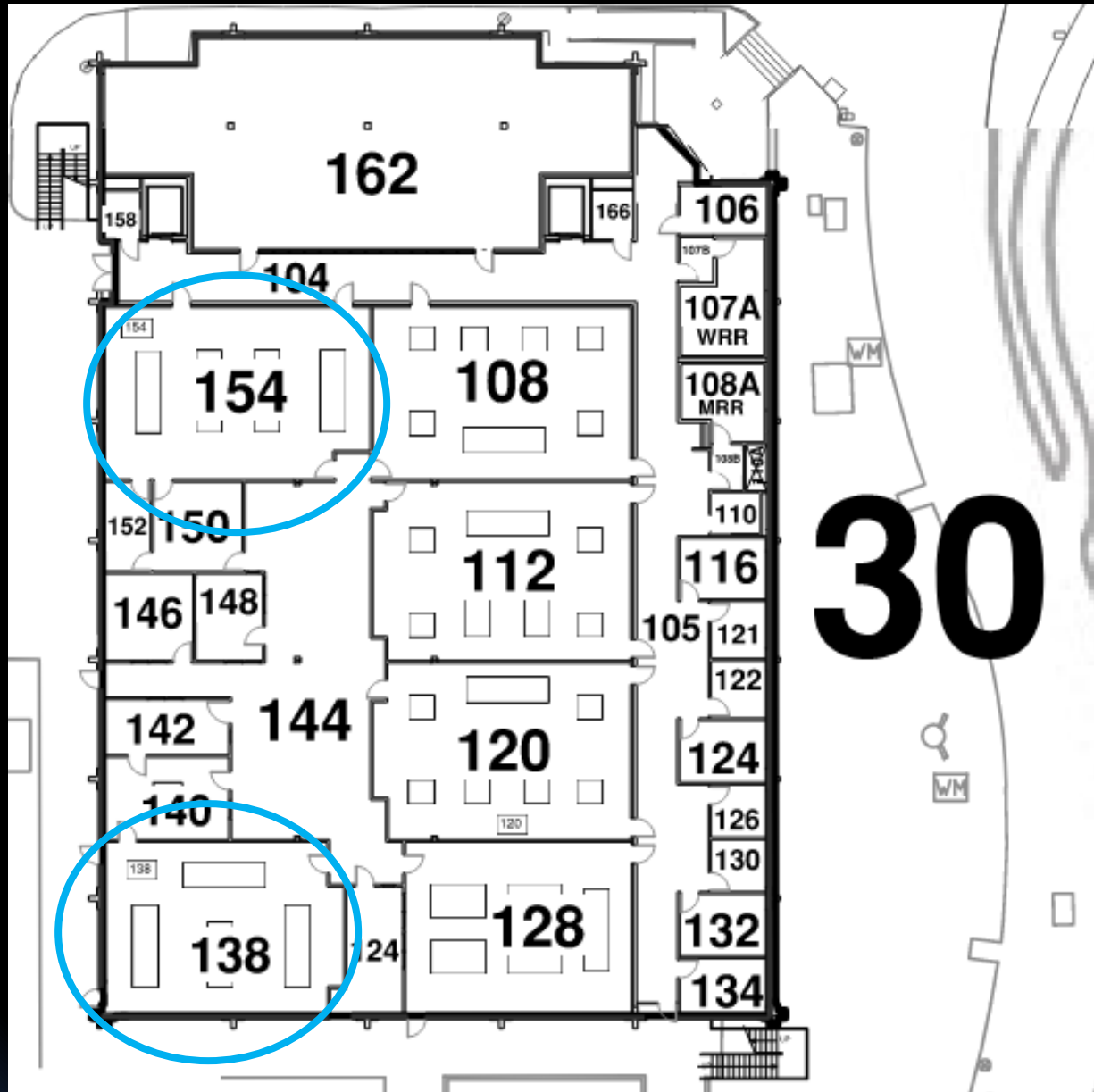

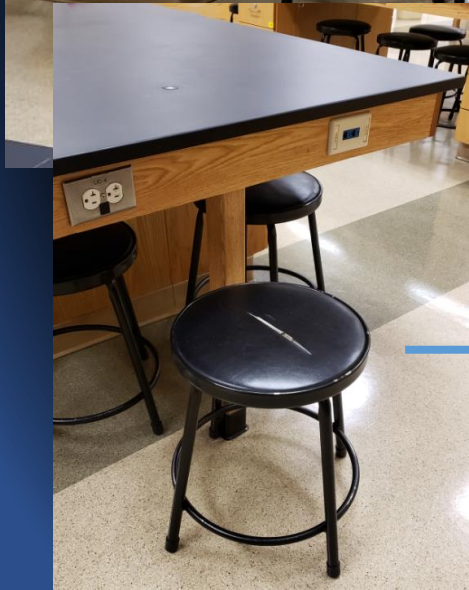

→ Change stools out with chairs with backs →

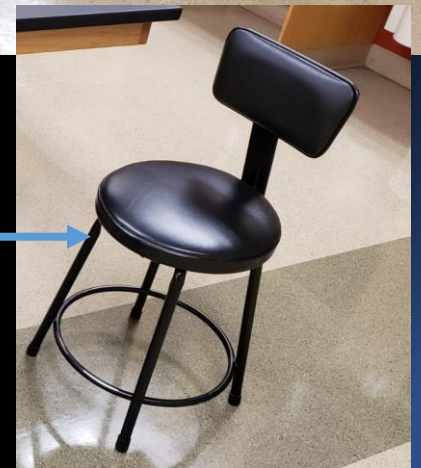

		Facilities Director Report	
	<b>COST</b>		<b>\$16,000.00</b>
2	Director's (1)	Construction impact on students/staff <b>(0 = Impact, 5 = No Impact)</b>	5
5	Director's (2)	Continual impact on FMO <b>(0 = Impact, 5 = No Impact)</b>	5
6	Director's (3)	Construction impact on FMO <b>(0 = Impact, 5 = No Impact)</b>	4
11	Director's (4)	Project Physical Feasibility	5
15	Director's (5)	Project Support Feasibility	5
19	Director's (6)	Cost Feasibility	5
23	Director's (7)	Project Start/Finish Feasibility	5
		<b>Project Total Score Out of %100</b>	<b>97</b>
Comments:			

# FPR 23-02 Culinary Electrical

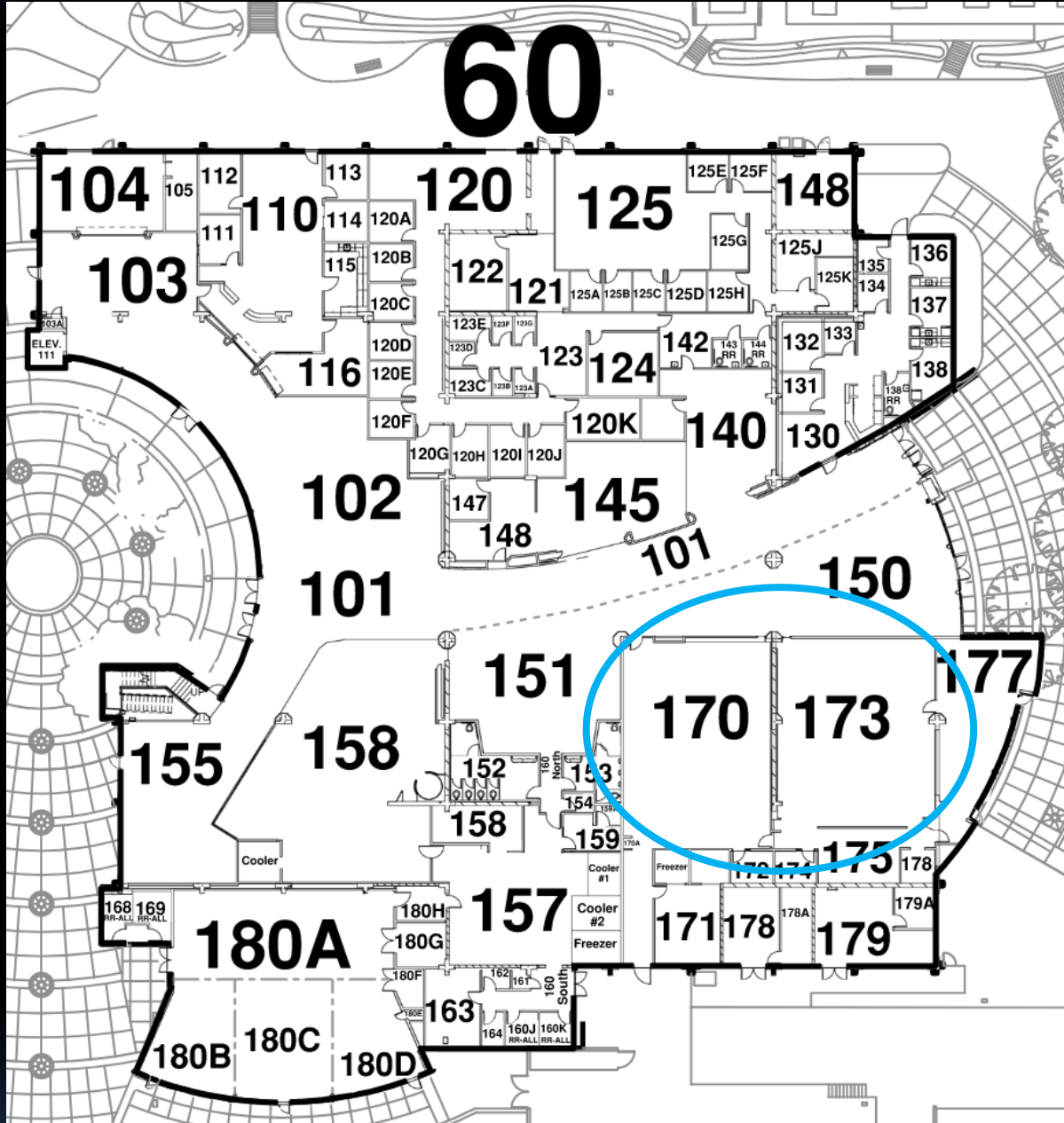

# FPR 23-02 Culinary Electrical



Add electrical from ceiling





		<b>Facilities Director Report</b>	
	<b>COST</b>		<b>\$75,000.00</b>
2	Director's (1)	Construction impact on students/staff <b>(0 = Impact, 5 = No Impact)</b>	4
5	Director's (2)	Continual impact on FMO <b>(0 = Impact, 5 = No Impact)</b>	5
6	Director's (3)	Construction impact on FMO <b>(0 = Impact, 5 = No Impact)</b>	4
11	Director's (4)	Project Physical Feasibility	5
15	Director's (5)	Project Support Feasibility	5
19	Director's (6)	Cost Feasibility	4
23	Director's (7)	Project Start/Finish Feasibility	3
		<b>Project Total Score Out of %100</b>	<b>86</b>
Comments:		The project makes sense to do. This a major electrical project that requires an outside contractor and could take a week or two to complete. Public bid contracts could take up to 4 months.	

# FPR 23-02 Bio Cabinets 30-128

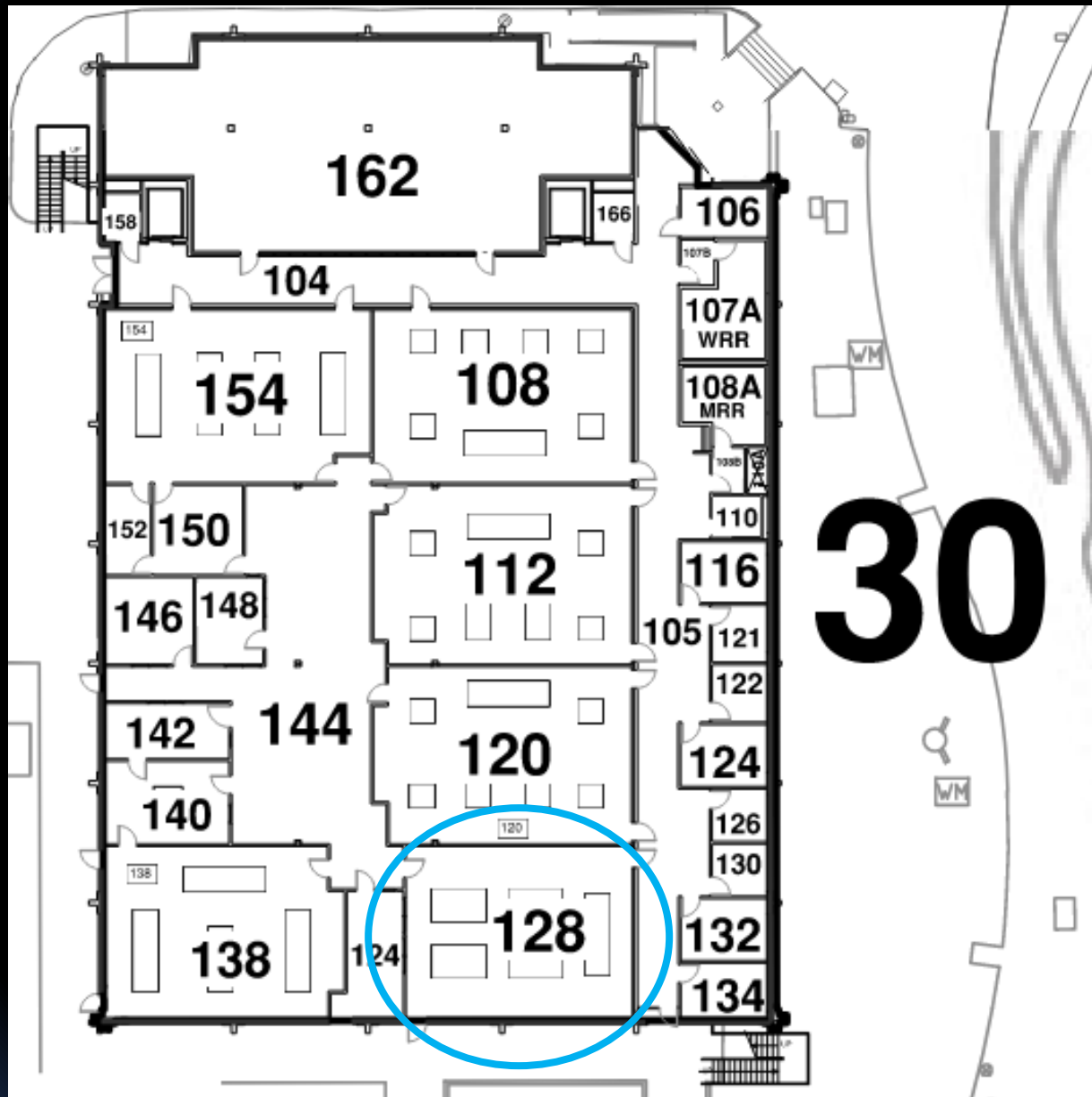

# FPR 22-01 Biology Cabinets

## History for the needed cabinets

- Three chemical hoods were removed
- A temporary countertop was installed



## New FPR

- Add upper cabinets similar to the other side of the lab



		Facilities Director Report	
	<b>COST</b>		<b>\$50,000</b>
2	Director's (1)	Construction impact on students/staff (0 = Impact, 5 = No Impact)	5
5	Director's (2)	Continual impact on FMO (0 = Impact, 5 = No Impact)	5
6	Director's (3)	Construction impact on FMO (0 = Impact, 5 = No Impact)	3
11	Director's (4)	Project Physical Feasibility	5
15	Director's (5)	Project Support Feasibility	5
19	Director's (6)	Cost Feasibility	5
23	Director's (7)	Project Start/Finish Feasibility	4
			<b>Project Total Score Out of %100 91</b>
Comments:		<p>These cabinets have been requested several times, but unfortunately monies have not been available. The cabinets are custom made to match existing cabinets in the lab and are very expensive, especially with inflation. Could take up to six months to get the contract and the cabinets made. Could take a week to install around scheduled class times.</p>	

# FPR 23-09 Nature Trail





- Add more steps for erosion control
- Work on fence
- Remove palms

		Facilities Director Report	
	COST		\$200,000
2	Director's (1)	Construction impact on students/staff (0 = Impact, 5 = No Impact)	3
5	Director's (2)	Continual impact on FMO (0 = Impact, 5 = No Impact)	2
6	Director's (3)	Construction impact on FMO (0 = Impact, 5 = No Impact)	2
11	Director's (4)	Project Physical Feasibility	5
15	Director's (5)	Project Support Feasibility	5
19	Director's (6)	Cost Feasibility	5
23	Director's (7)	Project Start/Finish Feasibility	5
<b>Project Total Score Out of %100</b>			<b>77</b>
Comments:		<p>The Nature Trail has been in dire need of attention for a long time. It is considered a lab classroom and should be treated as such. However, due to the lack of grounds workers (two for the whole campus) this cannot be done in-house. The \$6,000 that the requestor estimated for cost is not enough to even get materials in this inflated construction market. The \$200,000 would be for public bid drawings and contracts, project management, and contractors. The project will take up to nine months with about two months of construction.</p>	

# FPR 23-08 Transfer Center Space

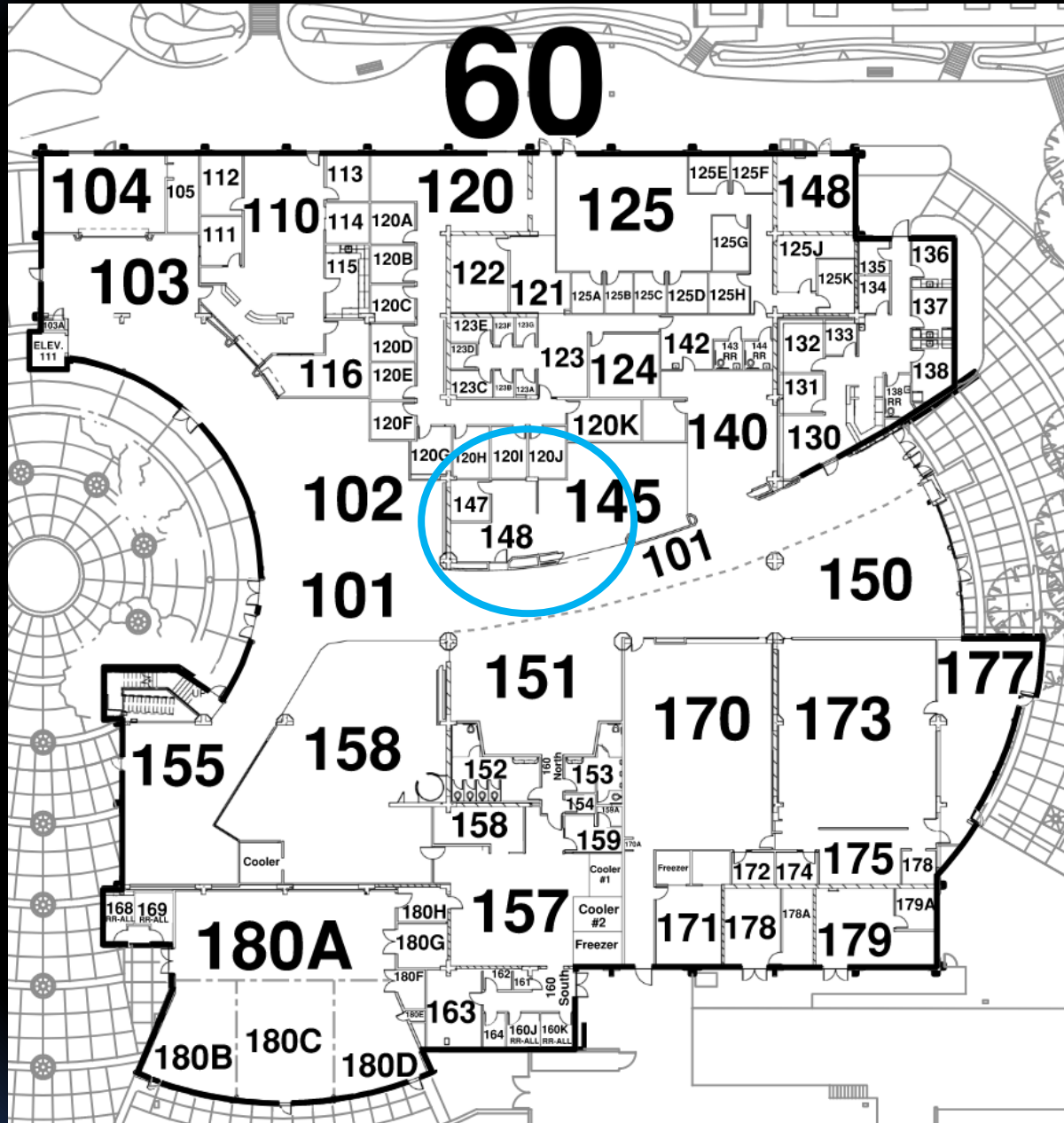



# FPR 23-08 Transfer Center Space

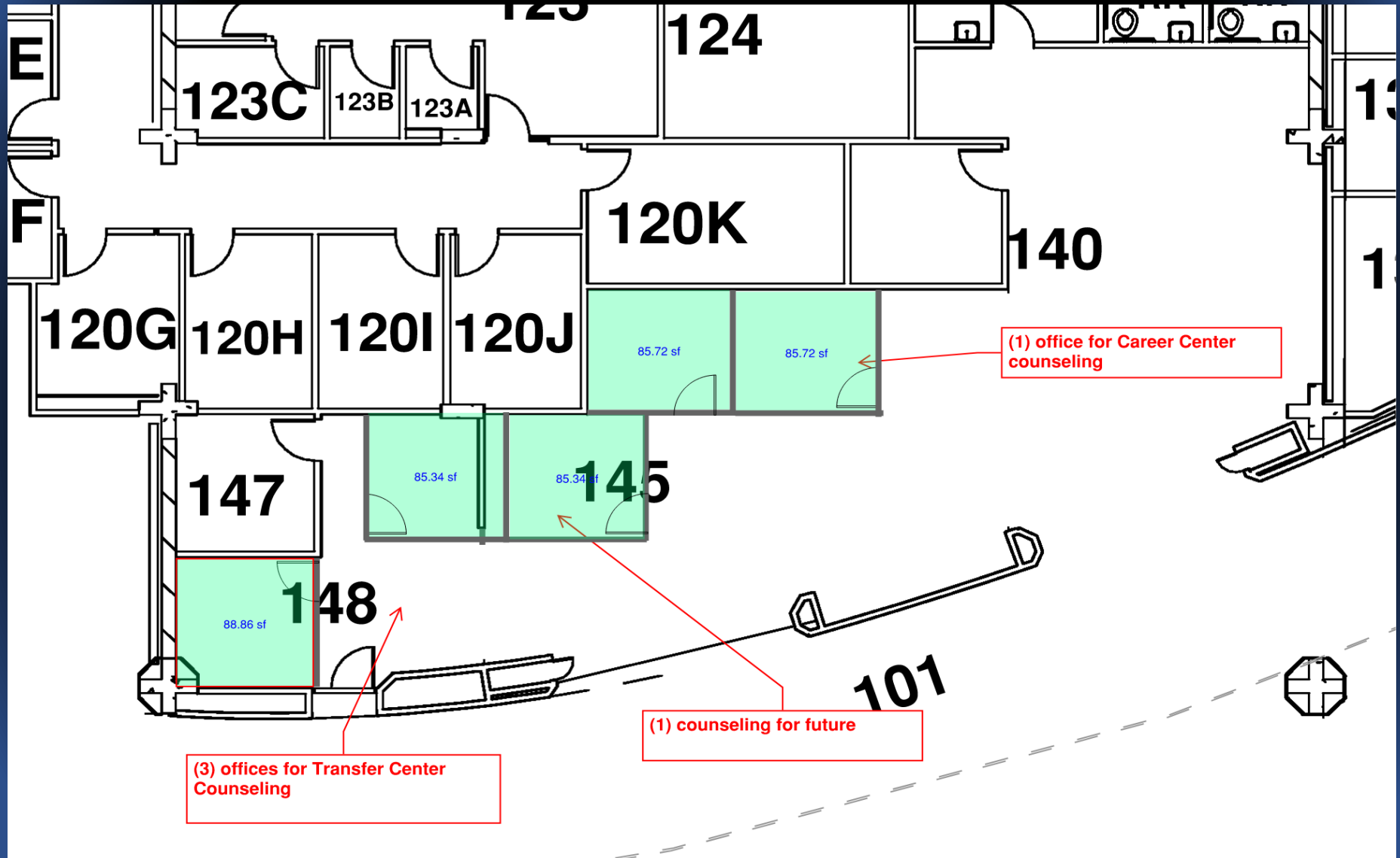

Before

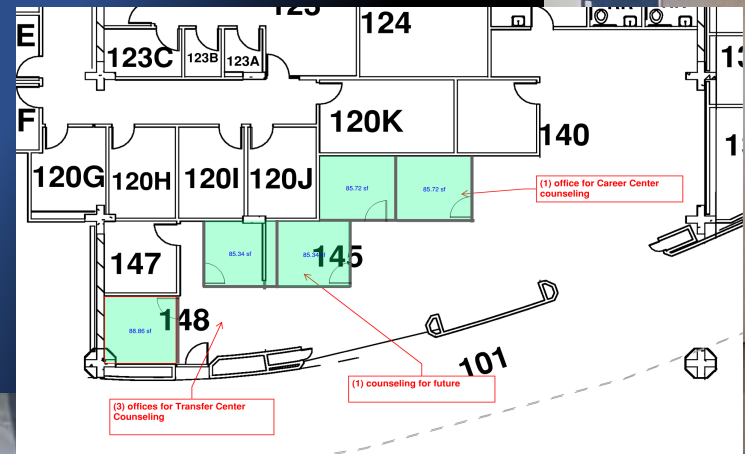

After





		<b>Facilities Director Report</b>	
	<b>COST</b>		<b>\$400,000</b>
2	Director's (1)	Construction impact on students/staff <b>(0 = Impact, 5 = No Impact)</b>	0
5	Director's (2)	Continual impact on FMO <b>(0 = Impact, 5 = No Impact)</b>	5
6	Director's (3)	Construction impact on FMO <b>(0 = Impact, 5 = No Impact)</b>	1
11	Director's (4)	Project Physical Feasibility	4
15	Director's (5)	Project Support Feasibility	5
19	Director's (6)	Cost Feasibility	3
23	Director's (7)	Project Start/Finish Feasibility	2
<b>Project Total Score Out of %100</b>			<b>57</b>
Comments:		<p>Project is definitely needed. The program would be displaced to do construction for about three months. The project will take about nine months from start to finish. Project includes public bid contract, project manager, architect, and contractors.</p>	